

High Speed Door 140 RA

Self Repairable[®] Exterior

Best solution for locations exposed directly to exterior areas and/or with high air pressures. It is fitted with flexible reinforcements that afford the canvas stiffness and facilitate rolling. Includes a system that allows, on impact against the canvas, it's leaving guides, to be introduced to guides, with the push of a button, so that repair and maintenance costs are minimized.

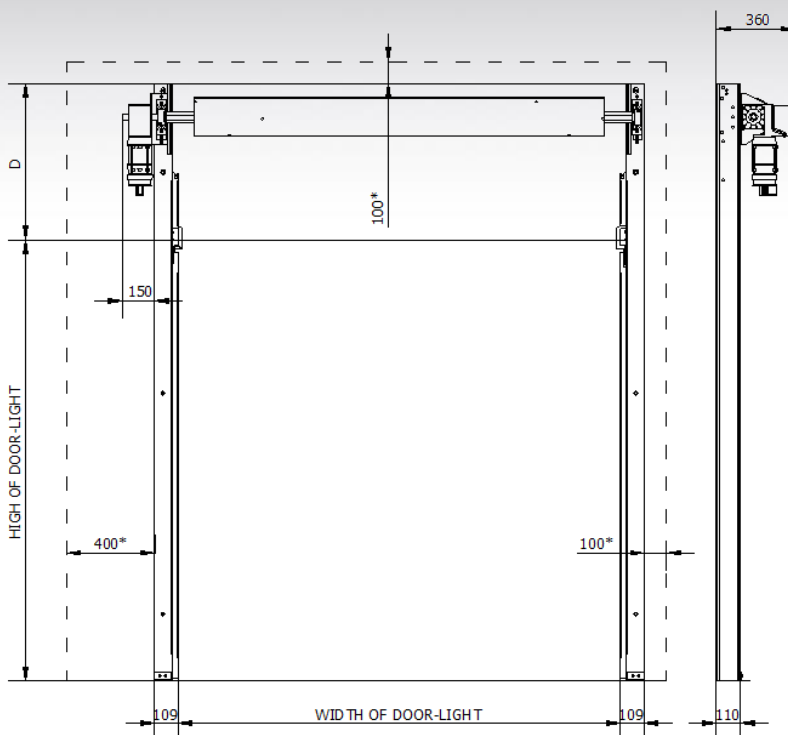

NOT DRUMCOVER	D = 700mm
STAINLESS STEEL DRUMCOVER	D = 710mm
ALUMINIUM XL DRUMCOVER	D = 730mm
CANVAS DRUMCOVER	D = 740mm

*Measures required for installation and maintenance operations.
(IN THE EVENT THAT THE DOOR HAS A COUNTERWEIGHT, LET 120mm FREE ON THE OPPOSITE SIDE TO THE MOTOR).

Product rule: EN 13241-1			
Selection of this rule	Essential characteristics	Units	Value
4.2.8	Safe opening	-	AGREE
4.2.5	Glass components	-	DO NOT APPLY
4.2.3	Mechanical resistance and stability	-	AGREE
4.3.3	Manual strength	-	AGREE
4.4.1	Water permeability	-	DO NOT APPLY
4.2.9	Danger substance emission	-	AGREE
4.4.3	Resistance to the wind load	Pa	450 Pa; Class 2 (≤ 98 km/h)
4.4.4	Direct noise reduction	dB(A)	DO NOT APPLY
4.4.5	Thermal resistance	W/(m ² ·K)	DO NOT APPLY
4.4.6	Air permeability	m ³ /(m ² ·h)	DO NOT APPLY
4.2.4 y 4.4.7	Durability	-	Cycles: 250.000

Self Repairable® Exterior 140 RA

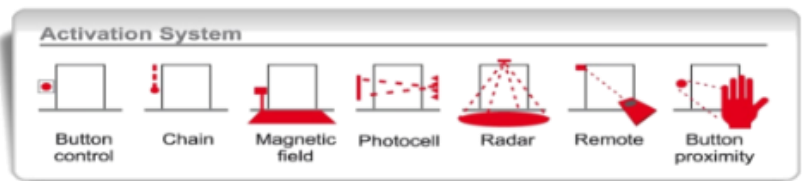
TECHNICAL DATA									
MAXIMUM MEASUREMENTS (mm)	W=5000 x H=5000								
APPLICATIONS AREA	EXTERIOR (0°C ~ +50°C)								
OPENING SPEED	STANDARD UP TO 1,2 m/s								
CLOSING SPEED	STANDARD DOWN TO 0,6 m/s								
STRUCTURE MATERIALS	ALUMINIUM								
ROLLED DRUM	ALUMINIUM								
CANVAS	FLAMEPROOF TYPE M2, THICKNESSES 0,8 mm (950gr/m2)								
GEARED MOTOR	DIRECT AXIS								
SAFETY SYSTEM	ANTI-DROP SYSTEM	OPTIONAL	COUNTERWEIGHT SYSTEM						
SENSITIVE SAFETY SYSTEM	PHOTOCELL								
CONTROL PANEL WITH CONVERTER AND AUTOMATON	MEASURES 300x400x200	PROTECTION IP66							
ELECTRIC SUPPLY	220-240 V a.c. (F+N+PE) 50-60 Hz 0,55-0,75 kW								
ACTIVATION SYSTEMS									
STRUCTURE COLOURS	<table border="1"> <tr> <td>LACQUERED</td> <td>9011</td> </tr> </table>			LACQUERED	9011				
LACQUERED	9011								
CANVAS COLOURS*	WHITE	9005	7016	3002	6026	5002	1003	7030	2004
	FOR OTHER COLOURS, PLEASE CONSULT								
	*OPTIONAL ANTISTATIC BLUE CANVAS								
WINDOWS CANVAS	STANDARD: 1 ROW OF WINDOWS								
ADDITIONAL FEATURES	SAS (INTERLOCK) ◻ ROLLER CONVEYOR ◻ DOUBLE HEIGHT ◻ COMMUNICATION ◻ ANTI-HUMIDITY KIT STAINLESS STEEL COMPONENTS ◻ IP 65 MOTOR AND PUSH BUTTONS ◻ FOR OTHER OPTIONS, PLEASE CONSULT.								

CONTROLSA, S.A reserves the right to change models and characteristics without prior warning. The technical data published in this catalogue is provided for information only, and entails no commitment whatsoever by CONTROLSA, S.A.

The total or partial reproduction of the data, drawings and/or photographs used in this catalogue is totally forbidden, as is any transmission by electronic, mechanical, reprographic or magnetic medium